

May 11, 2010

Texas Department of State Health Services  
Radiation Safety Licensing Branch  
MC-2003  
P.O. Box 149347  
Austin, Texas 78714-9347

Re: Radioactive Material License: L03321

Please amend our license as follows:

- Item 9 – add Family & Consumer Sciences Building Rooms 287A, 287E, 287L and 287M.  
See Attachment 1 for building floor plan indicating location of rooms.  
See Attachment 2 for drawing and description of Room 287A.  
See Attachment 3 for drawing and description of Room 287E.  
See Attachment 4 for drawing and description of Room 287L.  
See Attachment 5 for drawing and description of Room 287M.

Thank You,



William A. Hollingsworth

Attachment 1  
 Family & Consumer Sciences  
 Building #: 756  
 2nd Floor New Addition



Client:



Project Name:

Family & Consumer Sciences

Prepared By:



5849 Peachtree Road  
 Atlanta, GA 30349  
 1.800.445.4796  
 www.wayfindingthatworks.com

Legend/Specifications:

Areas shaded are to be designated as radioactive material handling areas.

Submittals:

04.12.10 - rev01, mlb	

This drawing and the ideas expressed remain the confidential property of INNERFACE. This drawing and its ideas are not to be reproduced, copied, or disclosed to any other person or entity without the express written consent of a representative of INNERFACE.

Scale: nts

Drawn By: mlb

Drawing Title: location plans

Sheet:

## Attachment 2

Floors are made of vinyl composition tile.  
Work area counter tops are made of epoxy resin  
that is water and chemical resistant.

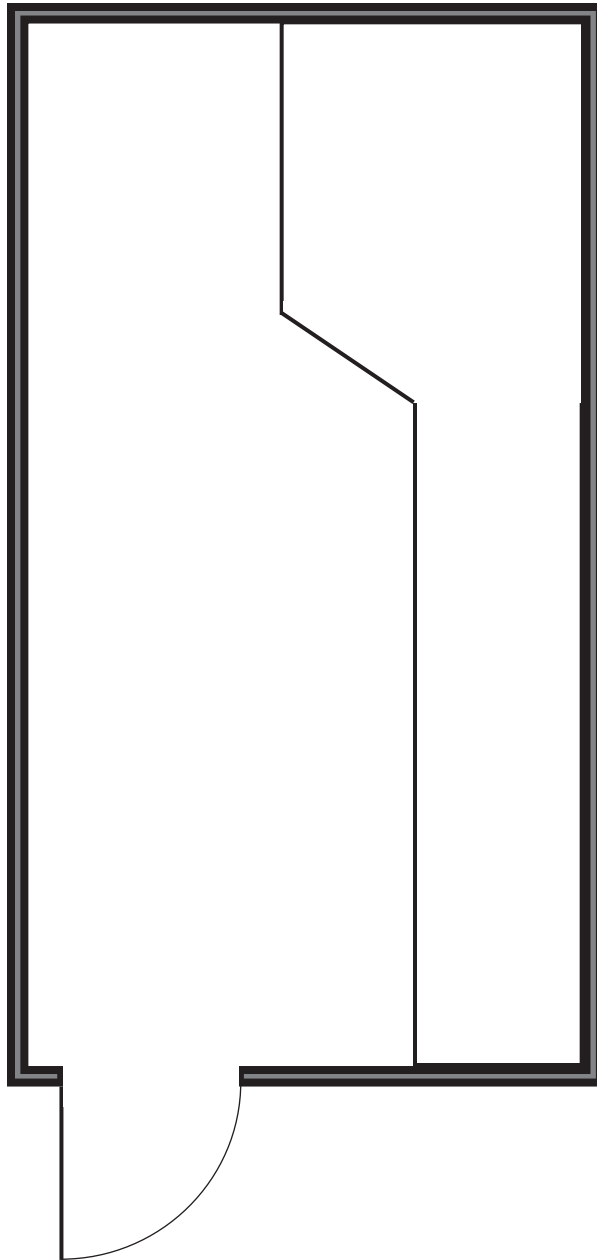

Family & Consumer Sciences  
Lab 287A

### Attachment 3

Floors are made of vinyl composition tile.  
Work area counter tops are made of epoxy resin  
that is water and chemical resistant.

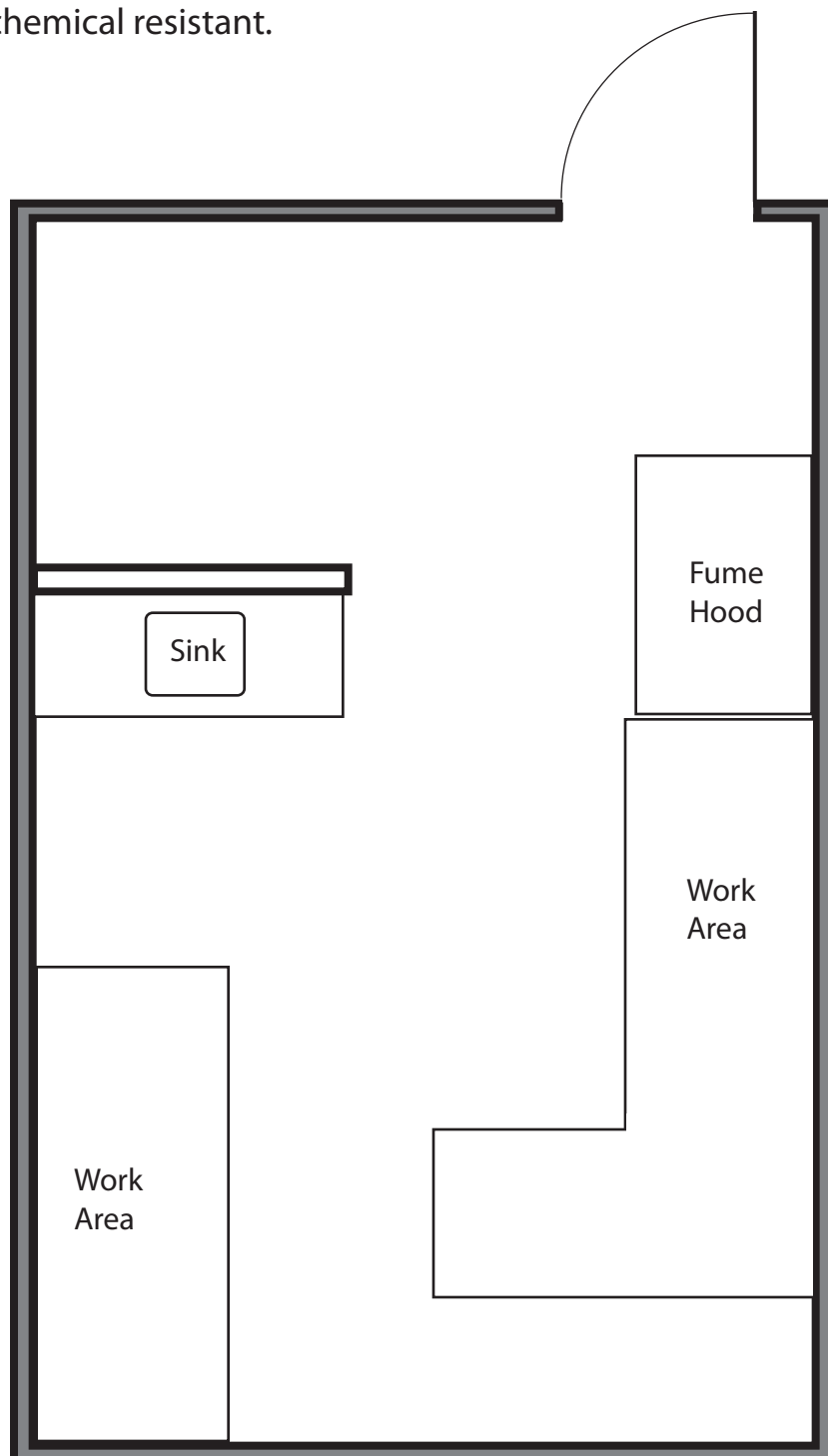

Family & Consumer Sciences  
Lab 287E

Attachment 4

Floors are made of vinyl composition tile.  
Work area counter tops are made of epoxy resin  
that is water and chemical resistant.

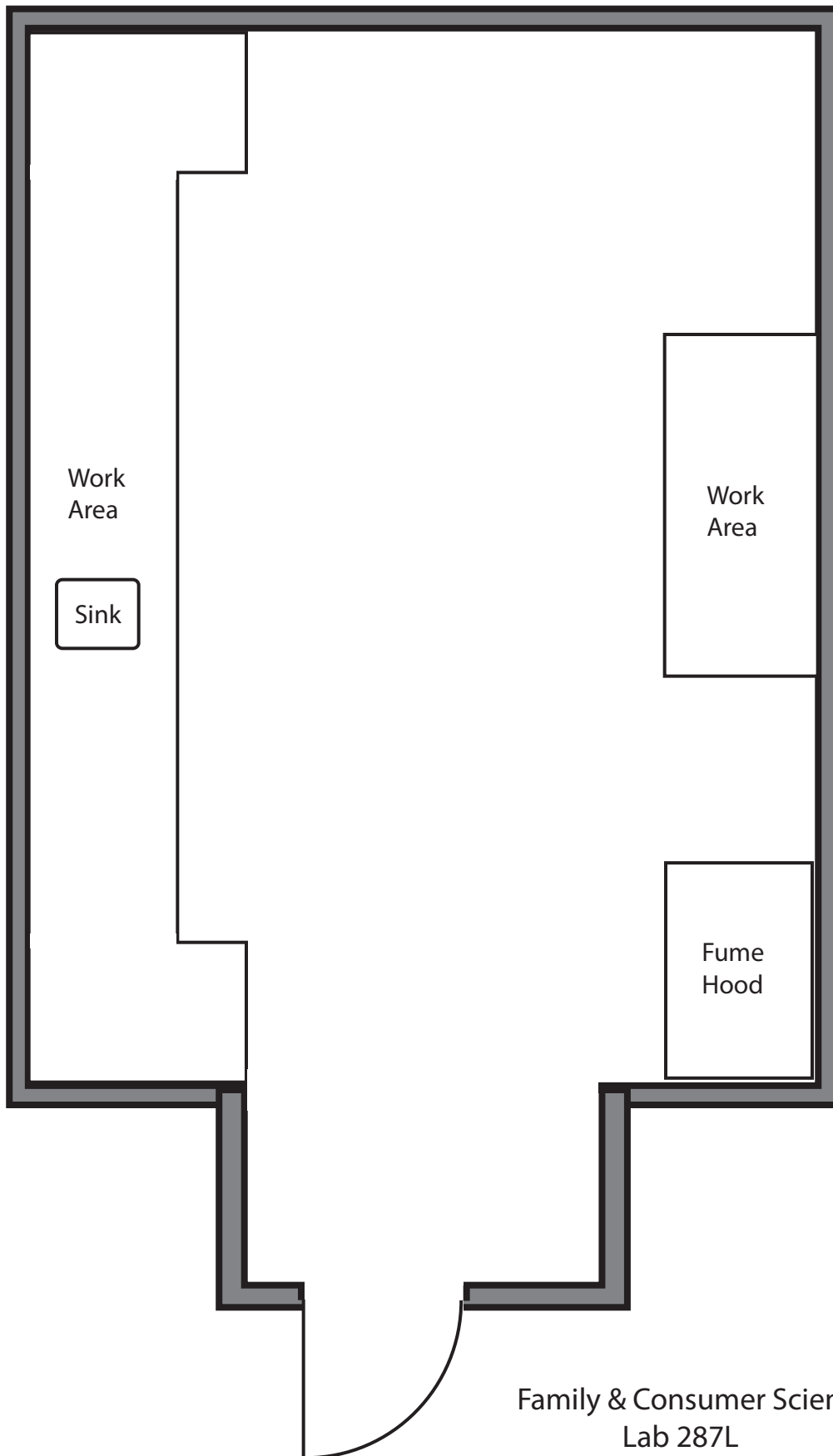

Family & Consumer Sciences  
Lab 287L

## Attachment 5

Floors are made of vinyl composition tile.  
Work area counter tops are made of epoxy resin  
that is water and chemical resistant.

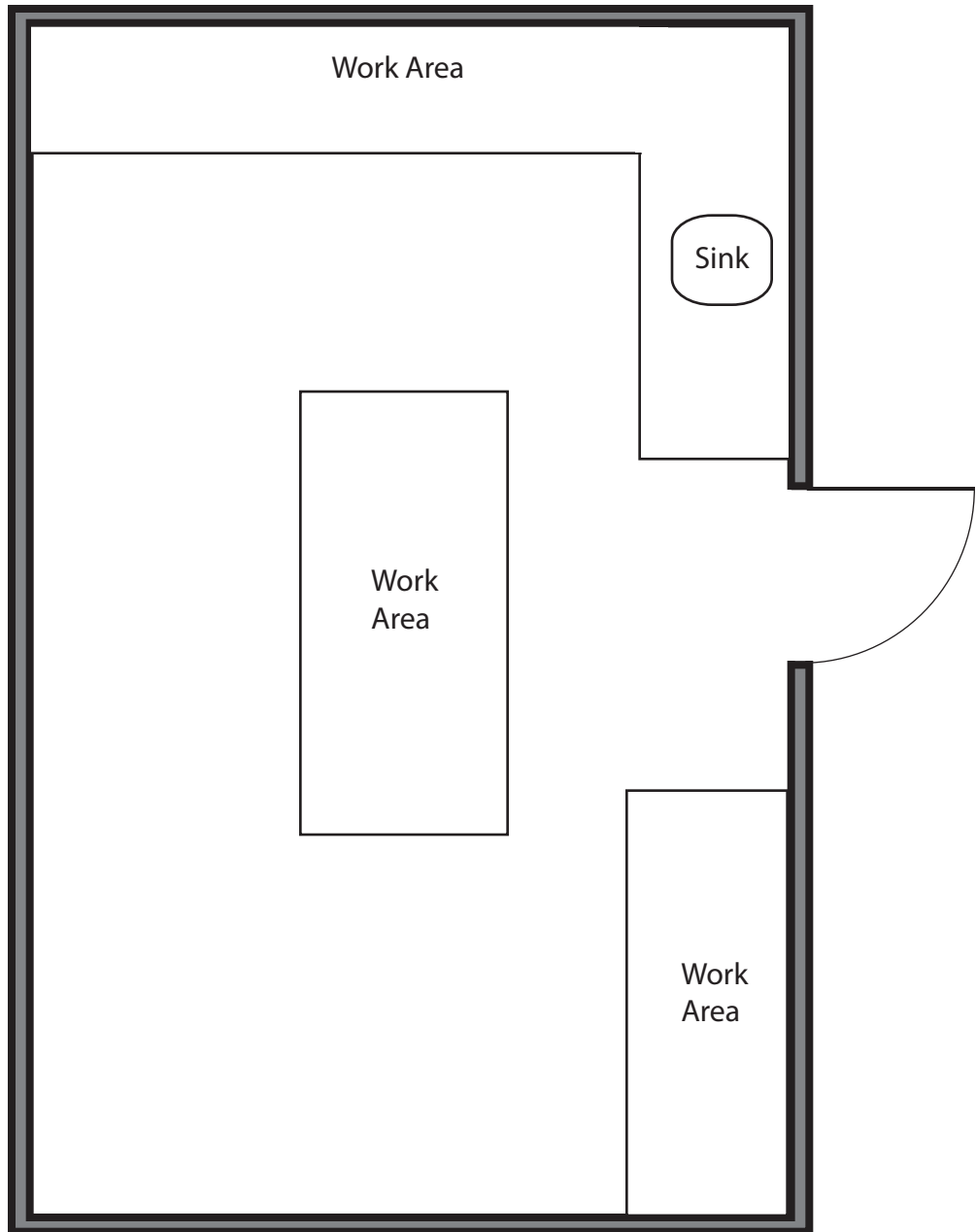

Family & Consumer Science  
Lab 287M